

Key

Proposed "No waiting at any time" (double yellow lines)

-	-
Revision	Date
	
STREETSCENE, LEISURE & TECHNICAL SERVICES	
Transportation Team Gibson Building Gibson Drive Kings Hill West Malling Kent ME19 4LZ Tel: 01732 844522 Fax: 01732 876317	
Project Title Parking Action Plan Phase 12 Informal consultation	
Drawing Title Borough Green Dark Hill Road	
Drawn ACB	Checked AE Date 7/2020
Scale 1 : 1000 @ A4	
Drawing No. DD/590/01	Rev -

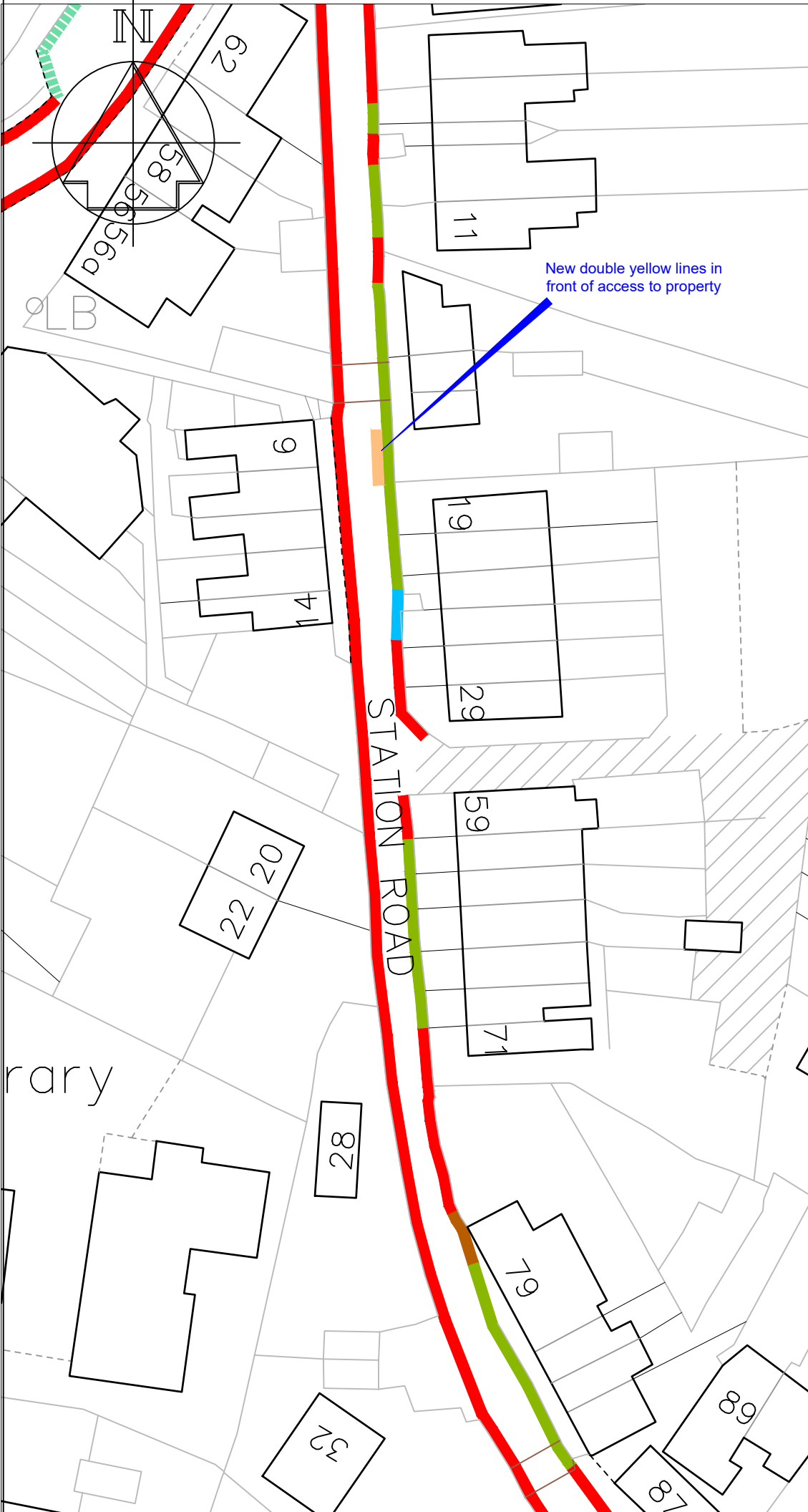

Key

- Existing "No waiting at any time" (double yellow lines)
- Existing limited waiting and permit parking bay
- Existing disabled parking bay
- Proposed "No waiting at any time" (double yellow lines)

-	-
Revision	Date



STREETSCENE,
LEISURE &
TECHNICAL SERVICES

Transportation Team
Gibson Building
Gibson Drive
Kings Hill
West Malling
Kent ME19 4LZ
Tel: 01732 844522 Fax: 01732 876317

Project Title
**Parking Action Plan
Phase 12
Informal consultation**

Drawing Title
**Borough Green
Station Road**

Drawn ACB | Checked AE | Date 7/2020

Scale 1 : 1000 @ A4

Drawing No. DD/590/02	Rev -
--------------------------	----------

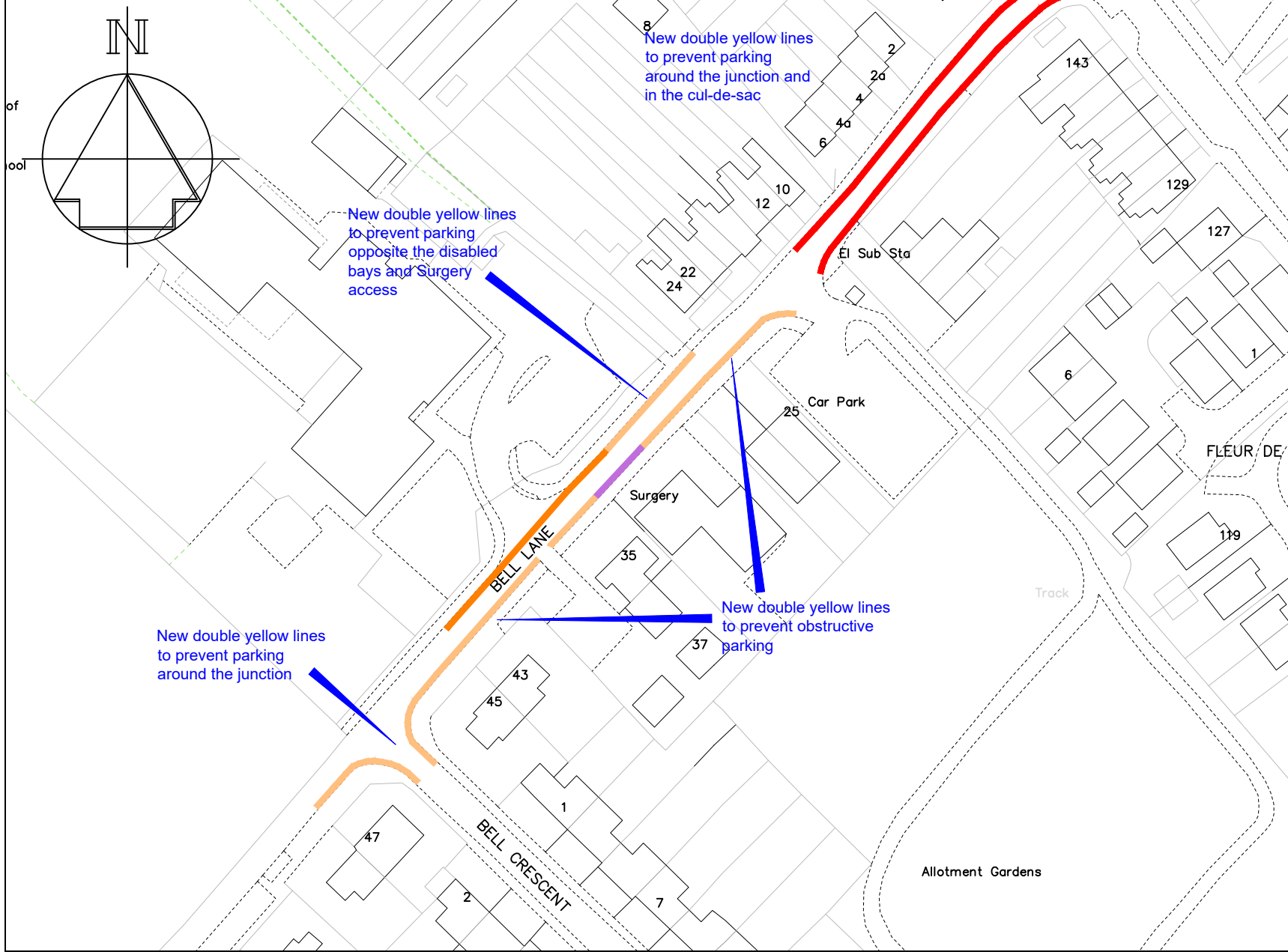

Key

- Existing 'No waiting at any time' (double yellow lines)
- Existing School Keep Clear, Mon-Fri, 8:30am-3:30pm (Yellow zig-zags)
- Existing disabled parking bay (2 cars)
- Proposed 'No waiting at any time' (double yellow lines)





Technical Services
 Gibson Building
 Gibson Drive
 Kings Hill
 West Malling
 Kent ME19 4LZ
 Tel: 01732 844522 Fax: 01732 876317

Project Title
 Parking Action Plan - Phase 12
 Informal consultation

Drawing Title
 Burham
 Bell Lane

Revision		Date
Drawn ACB	Checked AE	Date 7/2020
Scale 1:1000 @ A4		
Drawing No. DD/590/03		Rev -

Key

-  Existing "No waiting at any time" (double yellow lines)
-  Proposed "No waiting at any time" (double yellow lines)
-  Existing "School Keep Clear" (yellow zig-zag lines)

New double yellow lines to prevent obstructive parking in front of access and at entrance to parking areas, on bends and at junctions, and to prevent pavement parking

Revision		Date
		PLANNING, HOUSING & ENVIRONMENTAL HEALTH
Transportation Team Gibson Building Gibson Drive Kings Hill West Malling Kent ME19 4LZ Tel: 01732 844522 Fax: 01732 876317		
Project Title Parking Action Plan Phase 12 Informal consultation		
Drawing Title Ditton New Road, Kiln Barn Road, St Peters Road & Cherry Orchard		
Drawn ACB	Checked AE	Date 7/2020
Scale 1 : 1000 @ A4		
Drawing No. DD/590/04	Rev -	

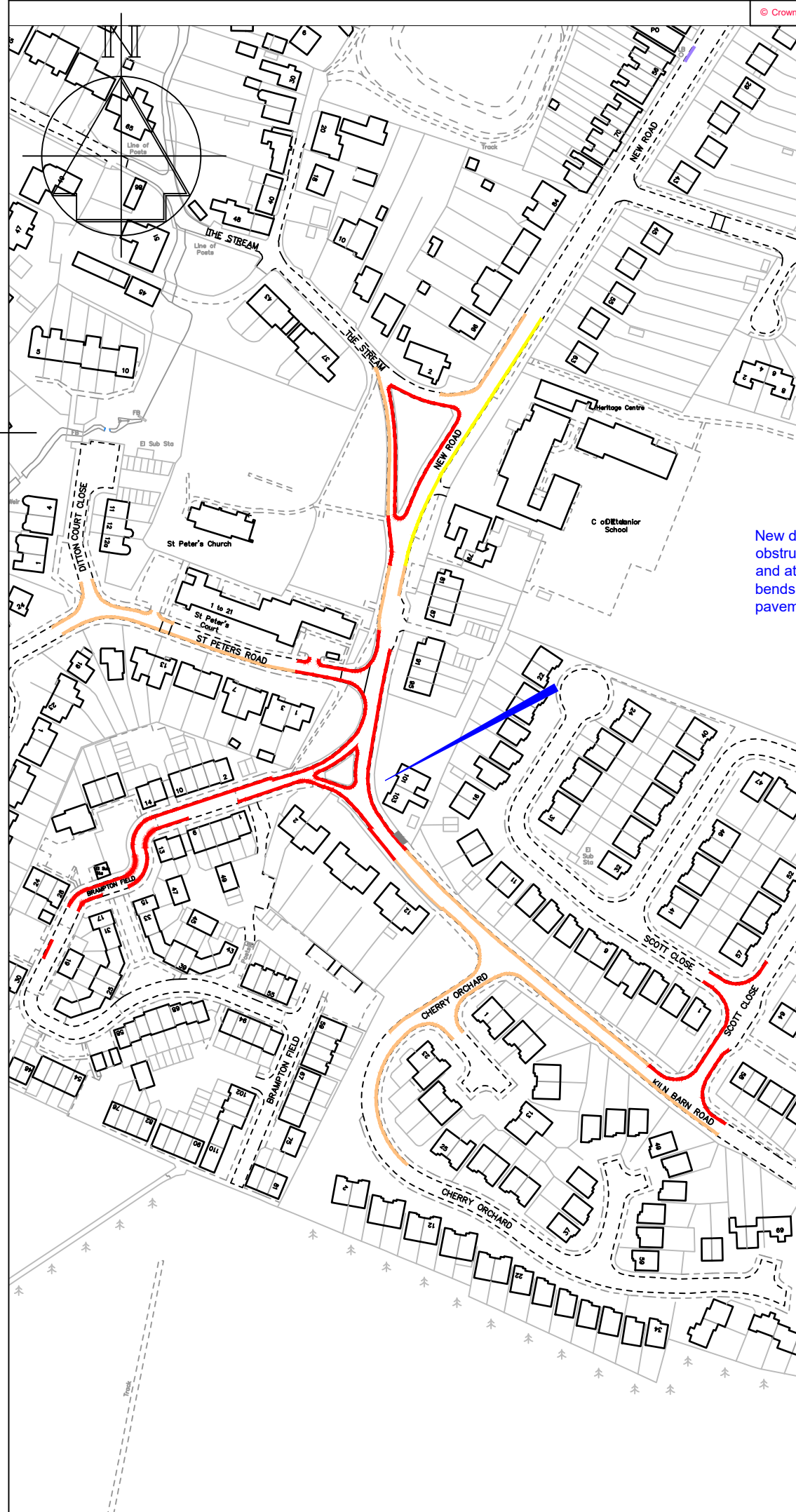

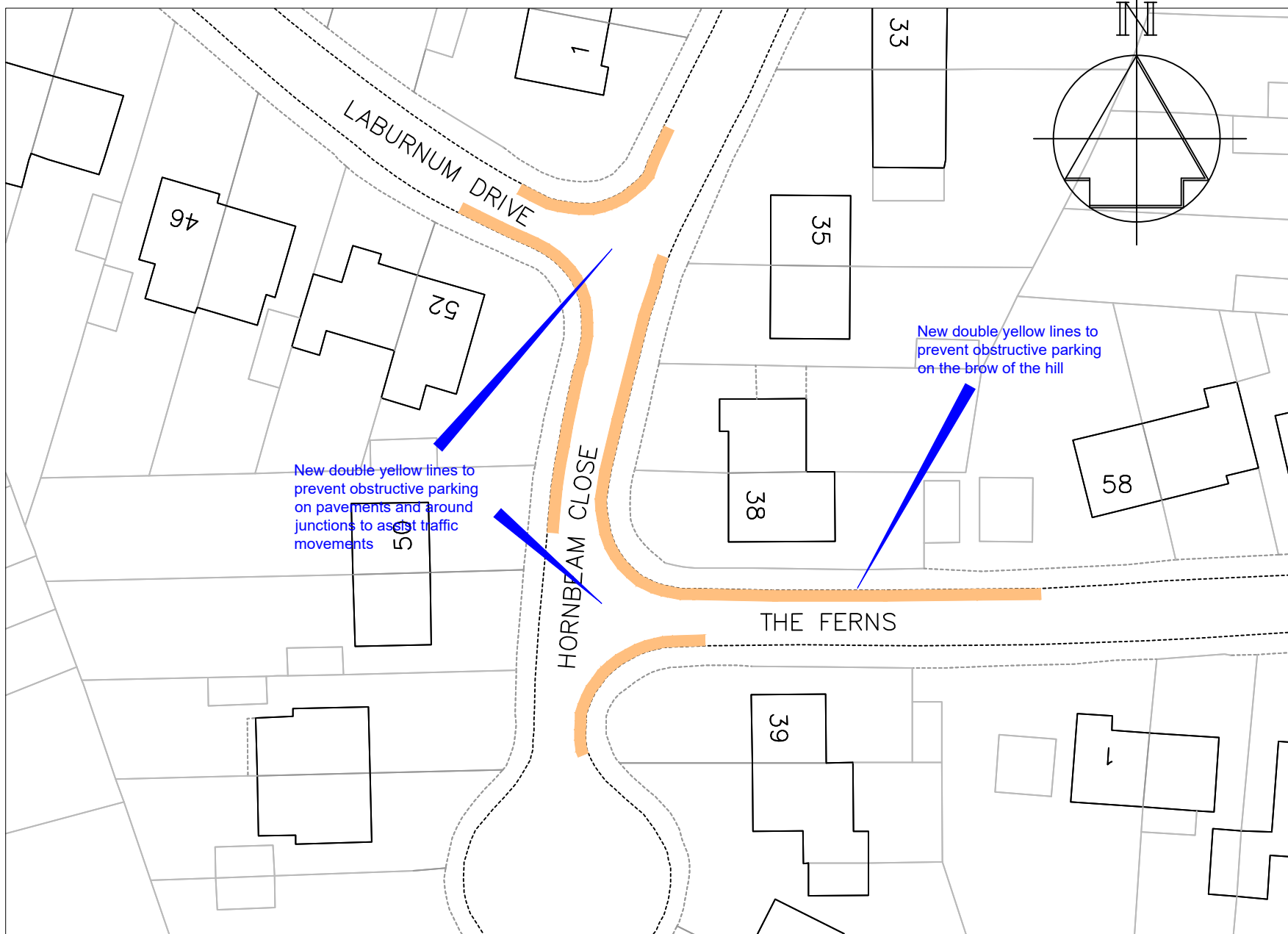

Key

— Proposed "No waiting at any time" (Double yellow lines)

-	-	-
Revision		Date
Drawn ACB	Checked AE	Date 7/2020
Scale 1 :500 @ A4		
Drawing No. DD/590/05		Rev -



Technical Services
 Gibson Building
 Gibson Drive
 Kings Hill
 West Malling
 Kent ME19 4LZ
 Tel: 01732 844522 Fax: 01732 876317

Project Title
 Parking Action Plan - Phase 12
 Informal consultation

Drawing Title
 Larkfield
 Laburnum Drive, Hornbeam Close
 and The Ferns

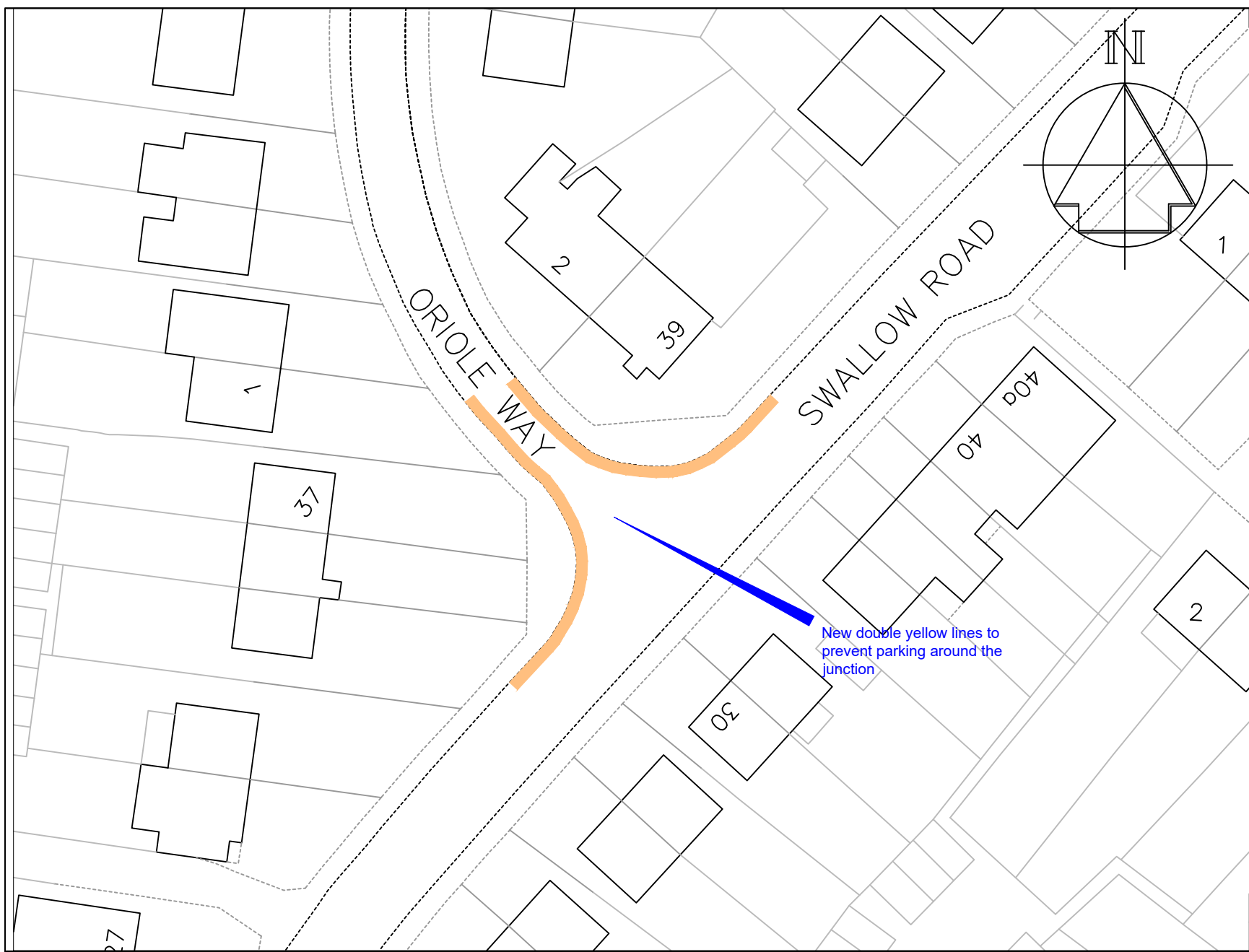

Key

— Proposed "No waiting at any time" (Double yellow lines)

-	-	-
Revision		Date



Technical Services
Gibson Building
Gibson Drive
Kings Hill
West Malling
Kent ME19 4LZ
Tel: 01732 844522 Fax: 01732 876317

Project Title
Parking Action Plan - Phase 12
Informal consultation

Drawing Title
Larkfield
Swallow Road & Oriole Way

Drawn ACB	Checked AE	Date 7/2020
Scale 1 : 500 @ A4		
Drawing No. DD/590/06		Rev -

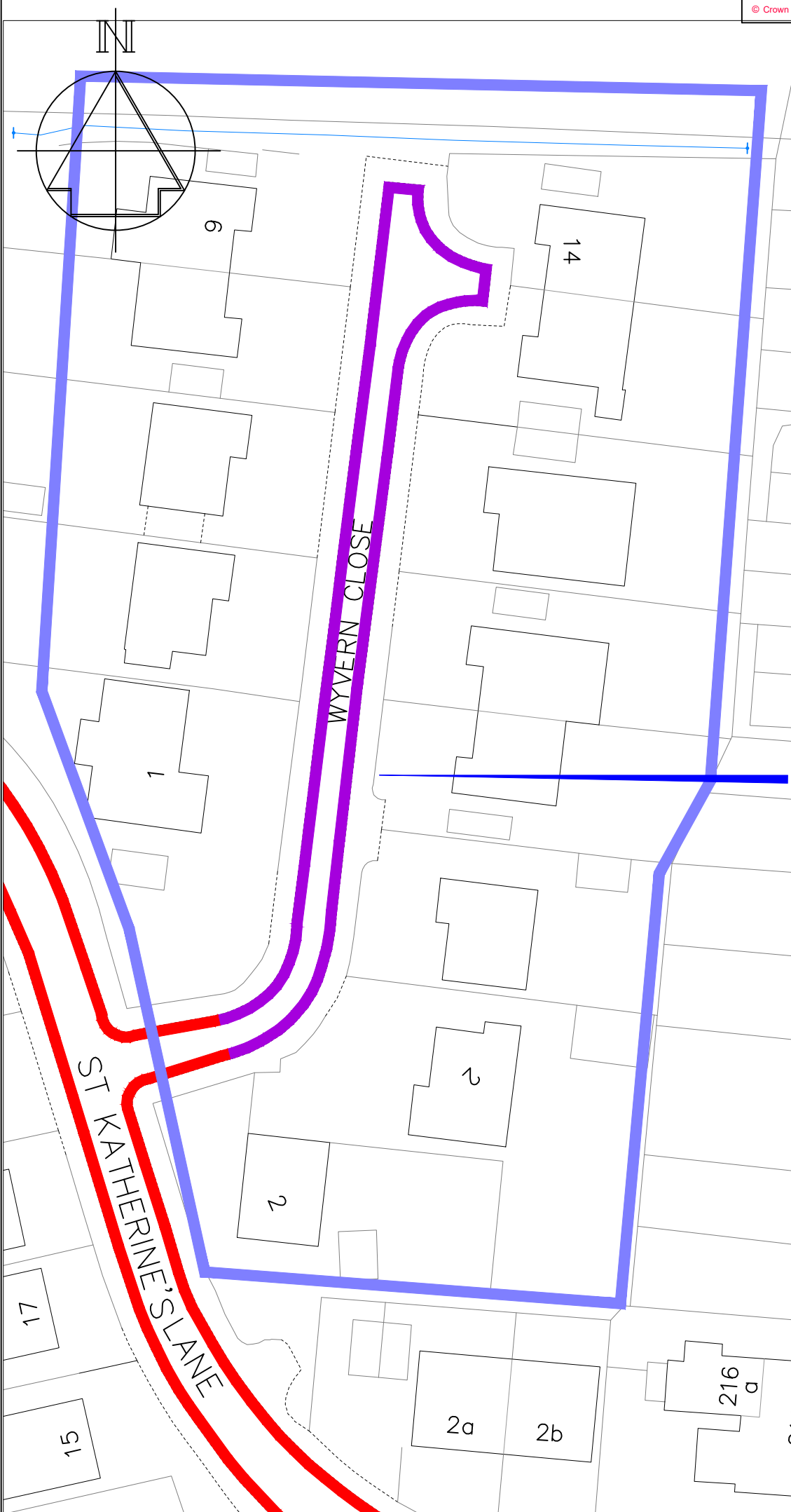

Key

- Existing 'No waiting at any time' (double yellow lines)
- Existing 'No waiting, Mon-Fri, 8-10am, 2-4pm (single yellow line) to be revoked
- Proposed "Permit Holders Only" area, Monday-Saturday, 8am-6pm

New permit parking area, restricting on-street parking to permit holders only during the restriction times to prevent non-resident parking. Permits are currently £40 per year

Visitors would require visitor parking permits, currently £1.20 per day

Revision		Date
		
Technical Services Gibson Building Gibson Drive Kings Hill West Malling Kent ME19 4LZ Tel: 01732 844522 Fax: 01732 876317		
Project Title Parking Action Plan Phase 12 Informal consultation		
Drawing Title Snodland Wyvern Close		
Drawn ACB	Checked AE	Date 7/2020
Scale 1 : 1000 @ A4		
Drawing No. DD/590/07		Rev -

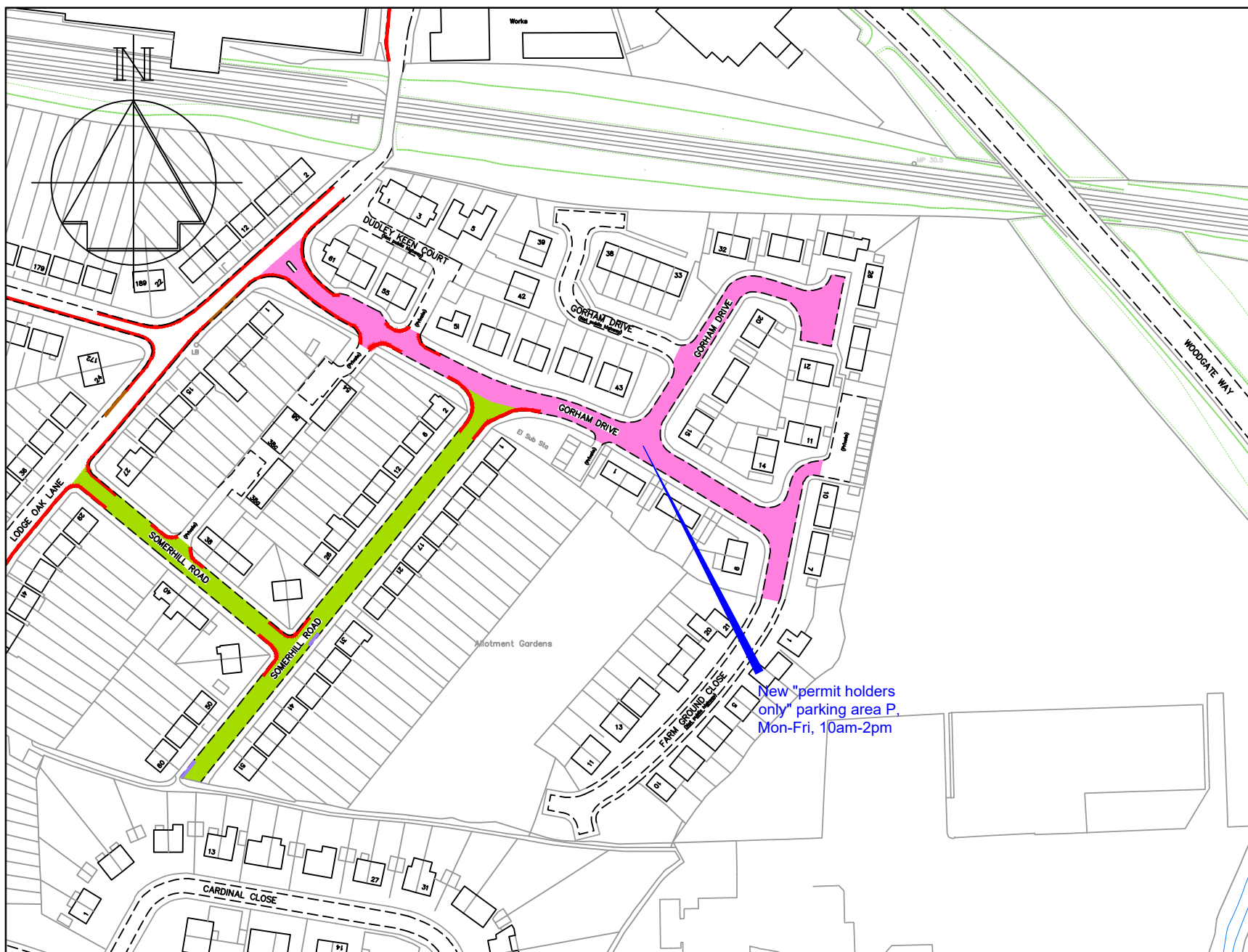

- ### Key
- Existing "No waiting at any time" (double yellow lines)
 - Existing "Permit holders only" area P, Mon-Fri, 10am-2pm
 - Proposed "Permit holders only" area P, Mon-Fri, 10am-2pm

There have been a number of requests for the neighbouring permit parking scheme to be extended to cover Gorham Drive to prevent non-resident parking during the week.

Permits are currently £40 per year

Visitors would require visitor parking permits, currently £1.20 per day

New "permit holders only" parking area P, Mon-Fri, 10am-2pm

-	-	-
Revision		Date

TONBRIDGE & MALLING
BOROUGH COUNCIL

STREETSCENE,
LEISURE &
TECHNICAL SERVICES

Transportation Team
Gibson Building
Gibson Drive
Kings Hill
West Malling
Kent ME19 4LZ
Tel: 01732 844522 Fax: 01732 876317

Project Title
Parking Action Plan - Phase 12
Informal consultation

Drawing Title
Tonbridge
Gorham Drive

Drawn ACB	Checked AE	Date 7/2020
---------------------	----------------------	-----------------------

Scale **1 : 2000 @ A4**

Drawing No. DD/590/08	Rev -
---------------------------------	-----------------

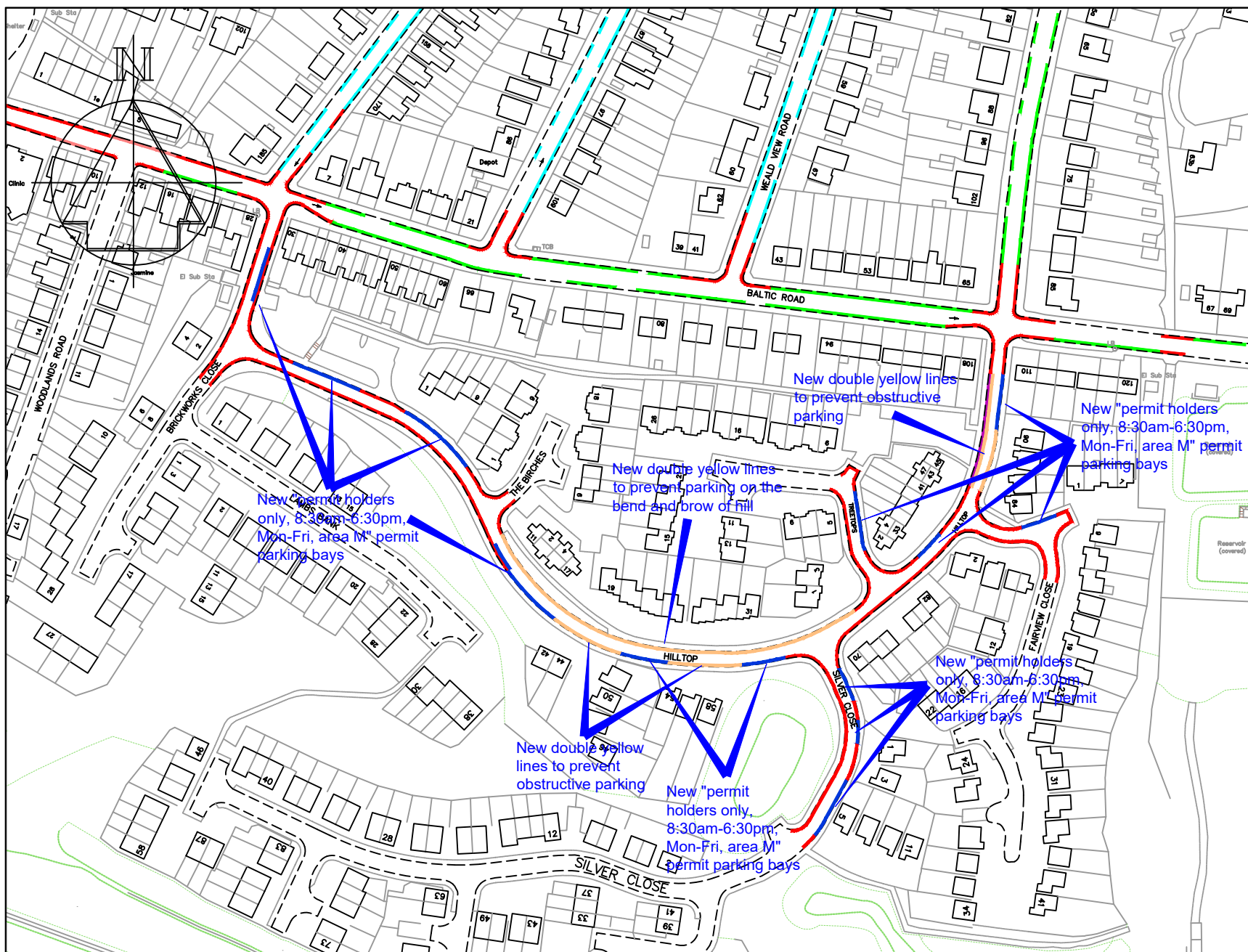

- ### Key
- Existing "No waiting at any time" (double yellow lines)
 - Existing "No waiting, Mon-Fri, 8am-6pm" (single yellow line)
 - Proposed "No waiting at any time" (double yellow lines)
 - Existing "Permit holders only, Mon-Fri, 9:30-10:30am, area M" permit parking bays
 - Existing "Permit holders only, Mon-Fri, 9:30-10:30am & 1pm-2pm, area M" permit parking bays
 - Proposed "Permit holders only, Mon-Fri, 8:30am-6:30pm, area M" permit parking bays

There have been a number of requests for the neighbouring permit parking scheme to be extended to cover Hilltop to prevent non-resident parking during the week.

Permits are currently £40 per year

Visitors would require visitor parking permits, currently £1.20 per day

-	-
Revision	Date



Transportation Team
 Gibson Building
 Gibson Drive
 Kings Hill
 West Malling
 Kent ME19 4LZ
 Tel: 01732 844522 Fax: 01732 876317

Project Title
Parking Action Plan - Phase 12
 Informal consultation

Drawing Title
Tonbridge Hilltop

Drawn	Checked	Date
ACB	AE	7/2020
Scale 1 : 2000 @ A4		
Drawing No.	Rev	
DD/590/09	-	

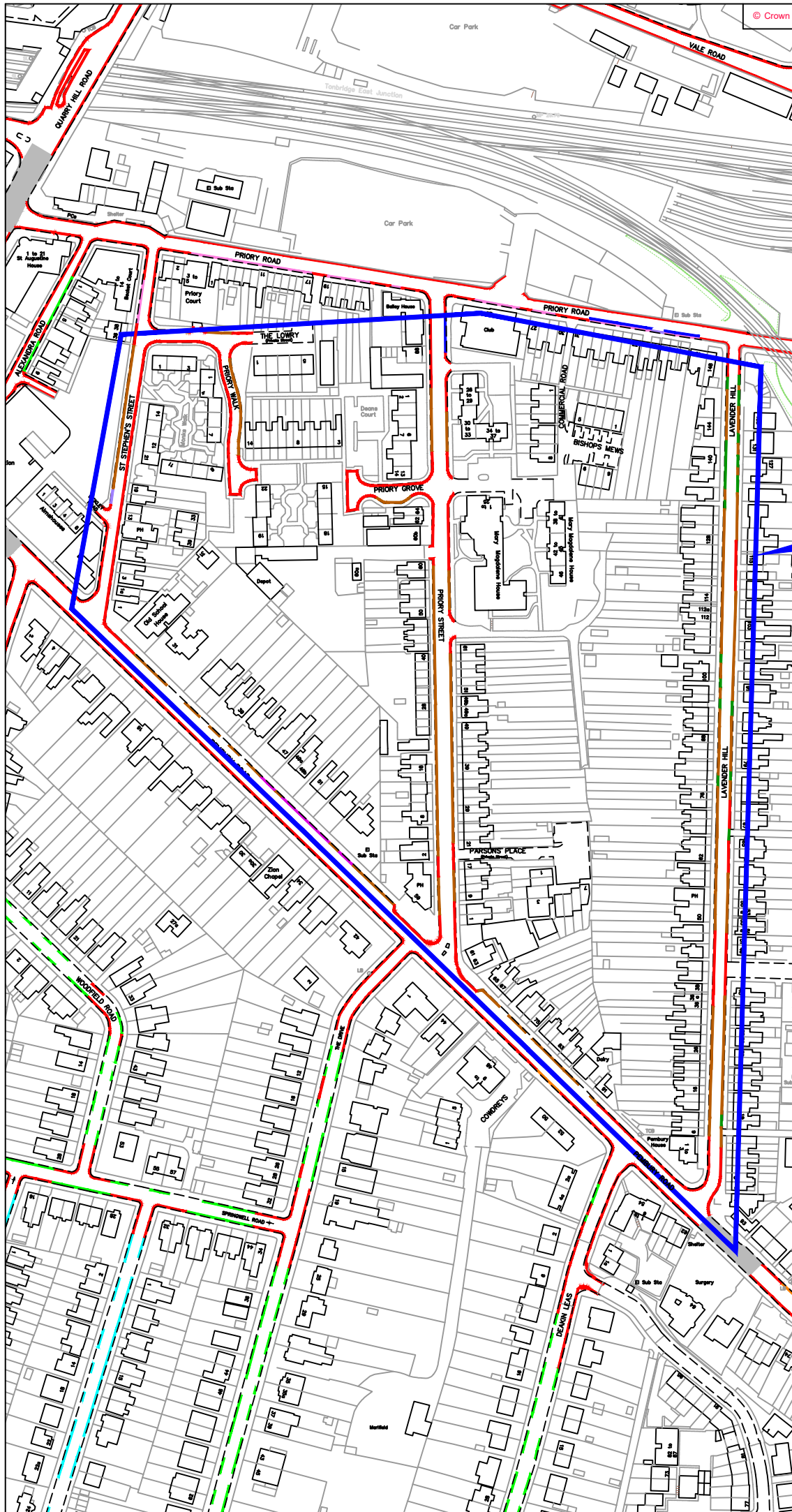

Key

 Existing Area N permit parking area Mon-Fri, 9:30-10:30am to be changed to Mon-Sat, 9:30-10:30am

Residents have reported parking issues on Saturdays, and have requested that the current permit parking restrictions be extended to cover Saturdays as well.

Revision	Date
	
Technical Services Gibson Building Gibson Drive Kings Hill West Malling Kent ME19 4LZ Tel: 01732 844522 Fax: 01732 876317	
Project Title Parking Action Plan Phase 12 Informal consultation Drawing Title Tonbridge Lavender Hill	
Drawn ACB	Checked AE Date 7/2020
Scale 1 : 2500 @ A4	
Drawing No. DD/590/10	Rev -

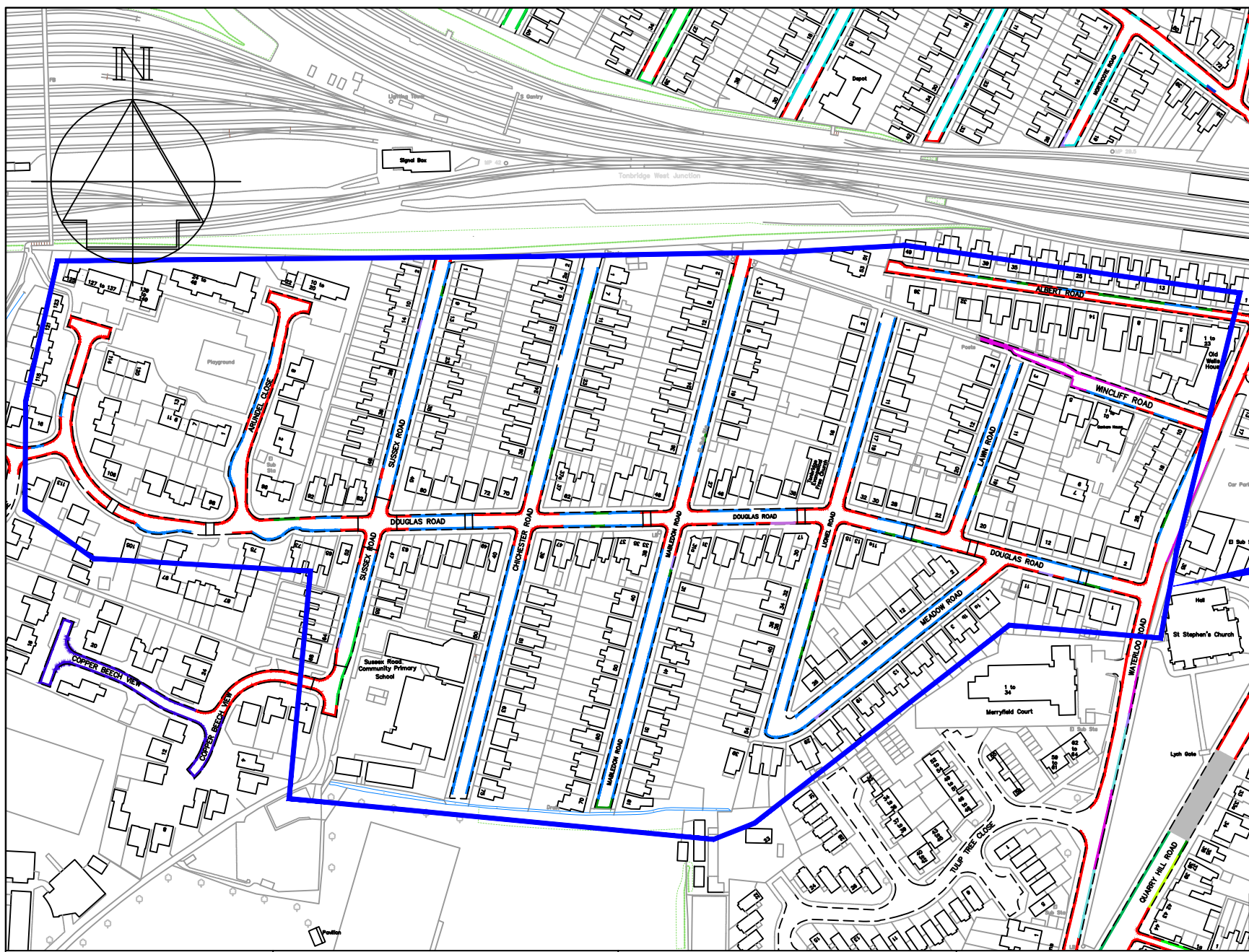

Key

— Existing Area G permit parking area
 Mon-Fri, 8:30-9:30am & 5-6pm to be changed to Mon-Sat, 8:30-9:30am & 5-6pm

Residents have reported parking issues on Saturdays, and have requested that the current permit parking restrictions be extended to cover Saturdays as well.

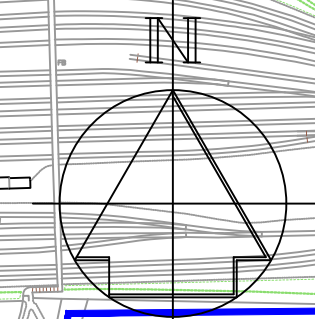

TONBRIDGE & MALLING
 BOROUGH COUNCIL

STREETSCENE,
 LEISURE &
 TECHNICAL SERVICES

Transportation Team
 Gibson Building
 Gibson Drive
 Kings Hill
 West Malling
 Kent ME19 4LZ
 Tel: 01732 844522 Fax: 01732 876317

Project Title
Parkign Action Plan - Phase 12
 Informal consultation

Drawing Title
Tonbridge
 Douglas Road area

Revision	Date
-	-

Drawn ACB	Checked AE	Date 7/2020
Scale 1 : 2500 @ A4		
Drawing No. DD/590/11	Rev -	

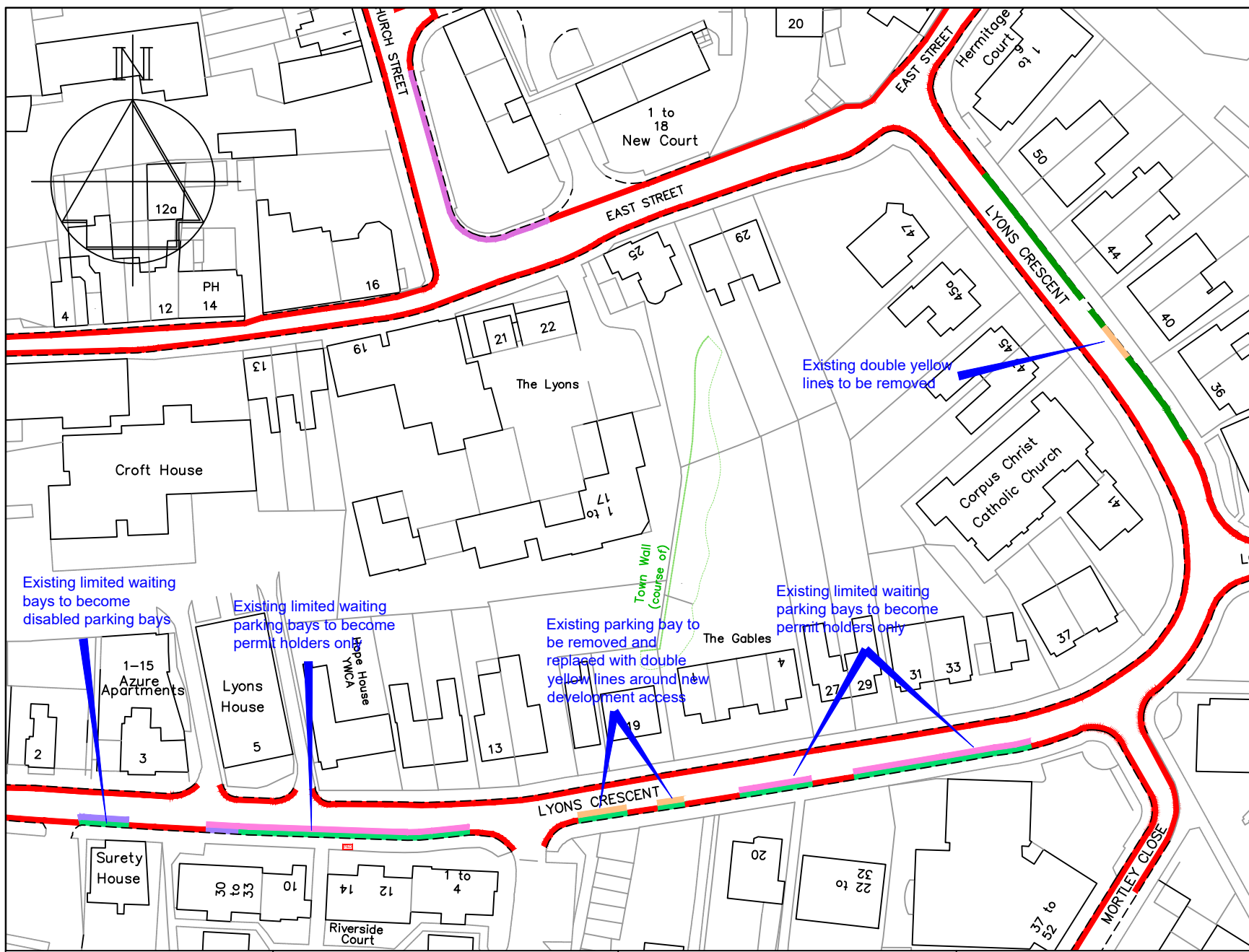

- ### Key
- Existing "No Waiting At Any Time" (double yellow lines)
 - Existing Mon-Sat 8-10am & 2-4pm Area L Permit parking bay
 - Existing white access protection marking (unenforceable)
 - Disabled parking bay
 - Existing Limited Waiting Mon-Sat 8am-6pm 2hrs, no return 2hrs and Area L permits
 - Proposed Permits only, Mon-Sat 8am-6pm, Area L permits
 - Proposed "No Waiting At Any Time" (double yellow lines)

Existing limited waiting bays to become disabled parking bays

Existing limited waiting parking bays to become permit holders only

Existing parking bay to be removed and replaced with double yellow lines around new development access

Existing limited waiting parking bays to become permit holders only

Existing double yellow lines to be removed

TONBRIDGE & MALLING
BOROUGH COUNCIL

STREETSCENE,
LEISURE &
TECHNICAL SERVICES

Transportation Team
Gibson Building
Gibson Drive
Kings Hill
West Malling
Kent ME19 4LZ
Tel: 01732 844522 Fax: 01732 876317

Project Title
Parking Action Plan - Phase 12
Informal consultation

Drawing Title
Tonbridge
Lyons Crescent

Drawn ACB	Checked AE	Date 7/2020
Scale 1 : 1000 @ A4		
Drawing No. DD/590/12		Rev

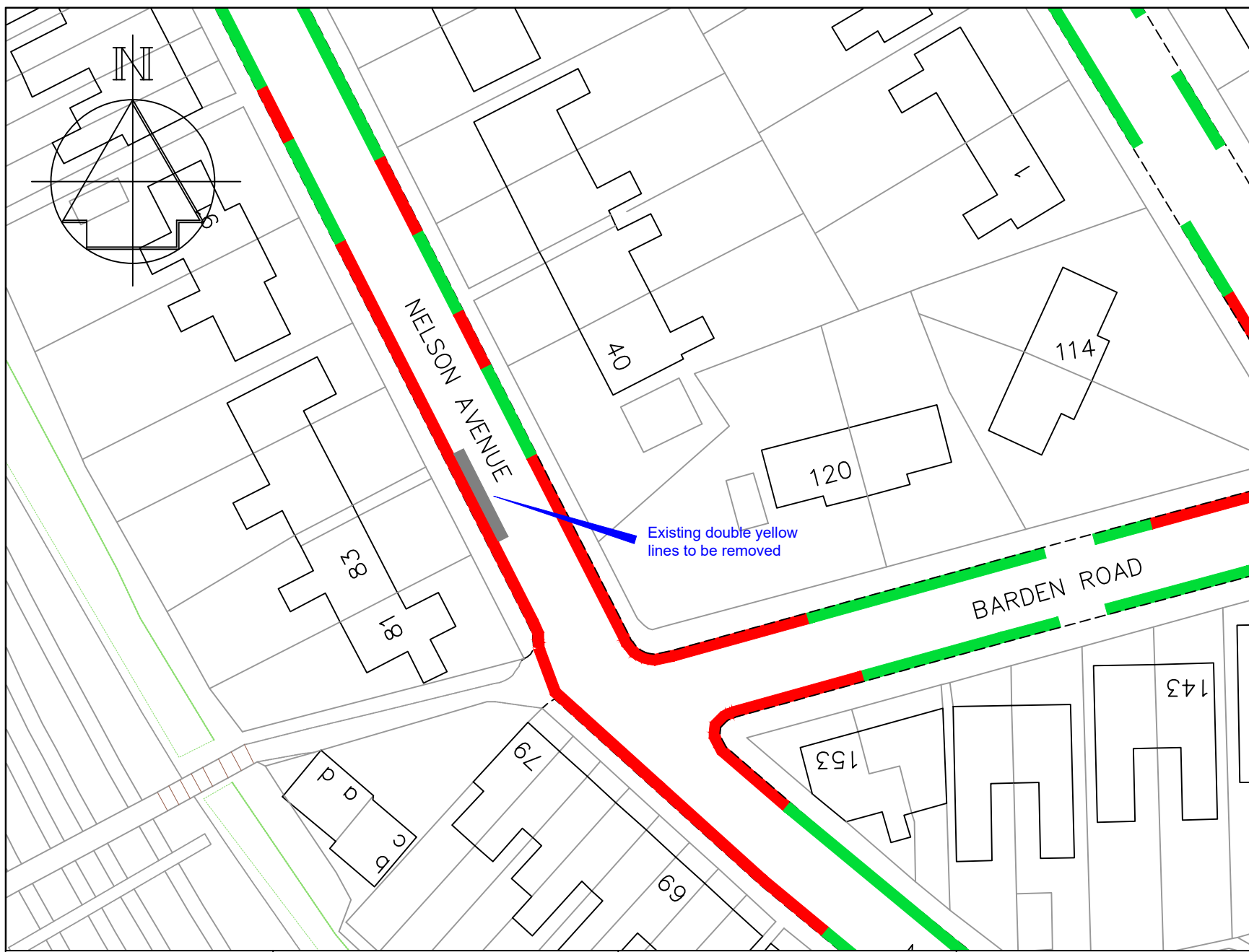

- ### Key
- Existing "No Waiting At Any Time" (double yellow lines)
 - Existing D1 & D2 Permit parking bay
 - Double yellow lines to be revoked and removed



STREETSCENE,
LEISURE &
TECHNICAL SERVICES

Transportation Team
Gibson Building
Gibson Drive
Kings Hill
West Malling
Kent ME19 4LZ
Tel: 01732 844522 Fax: 01732 876317

Project Title
Parking Action Plan - Phase 12
Informal consultation

Drawing Title
Tonbridge
Nelson Avenue

Drawn ACB	Checked AE	Date 7/2020
Scale 1 : 500 @ A4		
Drawing No. DD/590/13		Rev

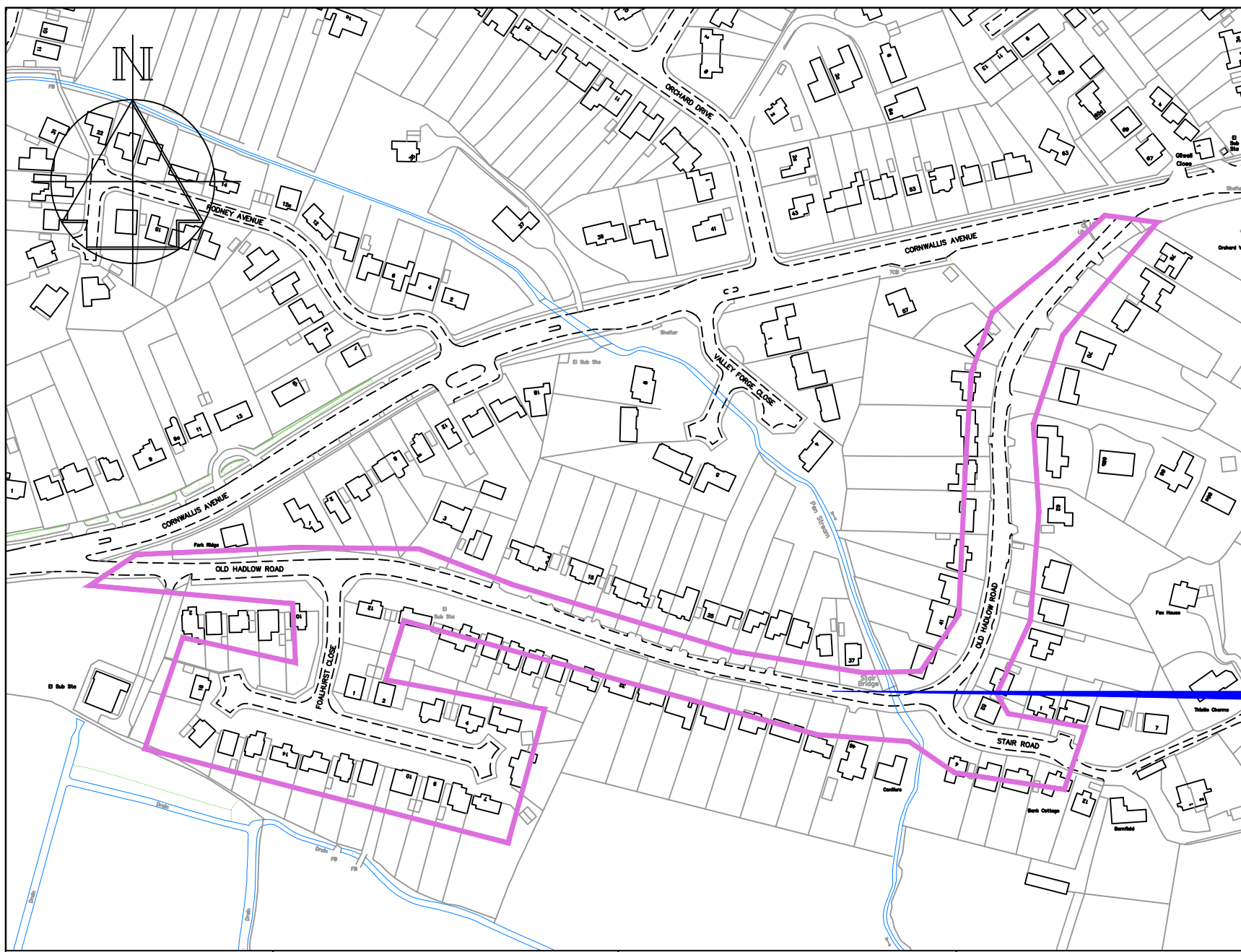

Key

— Proposed "Permit Holders Only" area, Monday-Saturday, 8am-6pm

New permit parking area, restricting on-street parking to permit holders only during the restriction times to prevent non-resident parking.
Permits are currently £40 per year

Visitors would require visitor parking permits, currently £1.20 per day



STREETSCENE,
LEISURE &
TECHNICAL SERVICES

Transportation Team
Gibson Building
Gibson Drive
Kings Hill
West Malling
Kent ME19 4LZ
Tel: 01732 844522 Fax: 01732 876317

Project Title
Parking Action Plan - Phase 12
Informal consultation

Drawing Title
Tonbridge
Old Hadlow Road

Drawn ACB	Checked AE	Date 7/2020
Scale 1 : 2500 @ A4		
Drawing No. DD/590/14		Rev

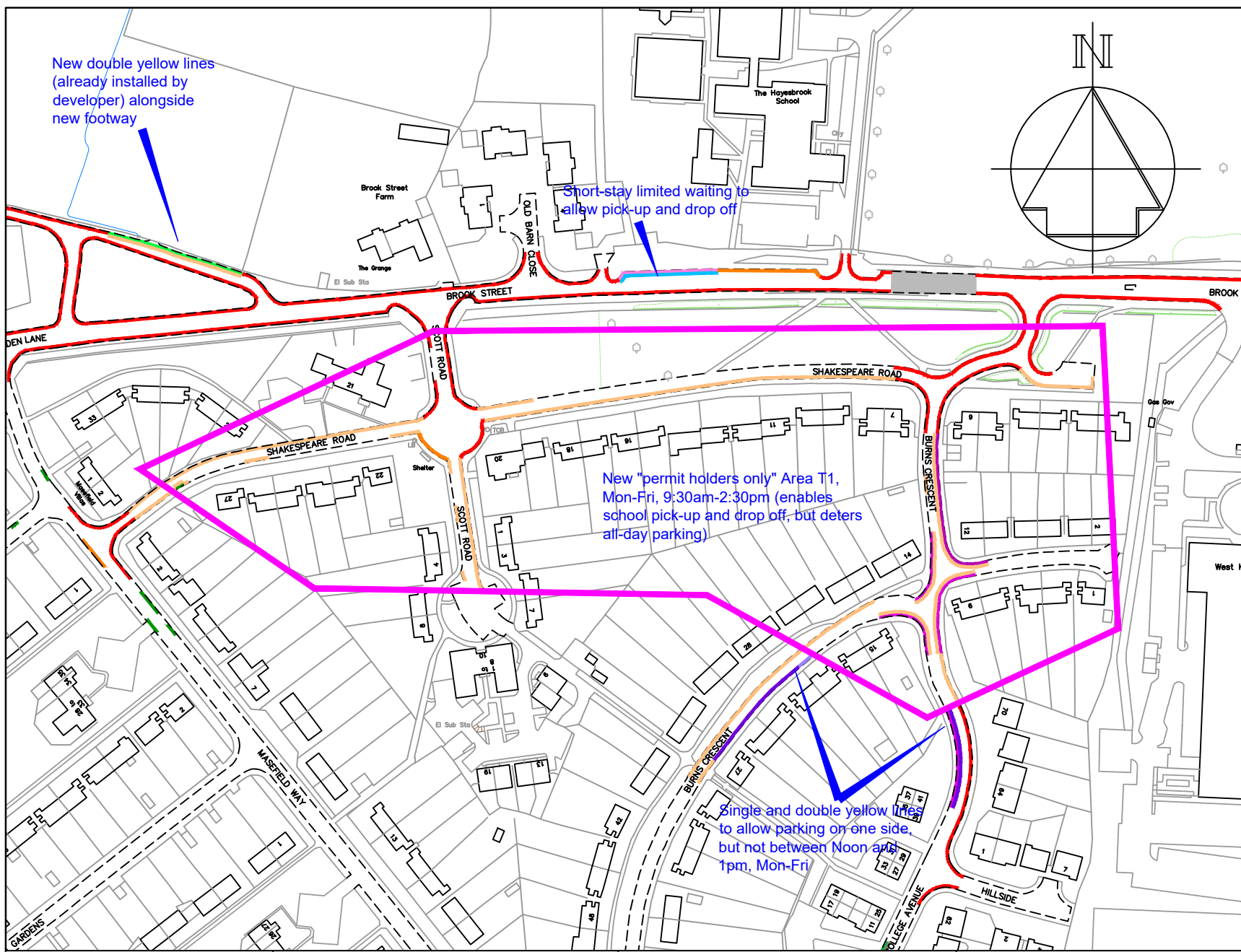

New double yellow lines (already installed by developer) alongside new footway

Short-stay limited waiting to allow pick-up and drop off

New "permit holders only" Area T1, Mon-Fri, 9:30am-2:30pm (enables school pick-up and drop off, but deters all-day parking)

Single and double yellow lines to allow parking on one side, but not between Noon and 1pm, Mon-Fri

Key

- Existing "No waiting at any time" (double yellow lines)
- Existing "No waiting, Mon-Fri, 10:30-11am" (single yellow line)
- Existing "No waiting, Mon-Sat, 8am-6pm" (single yellow line)
- Existing "Disabled bay"
- Existing bus stop clearway or bus stand
- Existing unenforceable "Access protection" (white driveway line)
- Existing pedestrian crossing controlled zone (white zig-zags)
- Existing "Limited waiting, Mon-Fri, 8am-6pm, 20m no return 40m" (short stay parking bay)
- Proposed "No waiting, Mon-Fri, Noon-1pm" (single yellow line)
- Proposed "Limited waiting, Mon-Fri, 8am-6pm, 1hour, no return 1hour" (short stay parking bay)
- Proposed "T1 Permit holders only" area, Mon-Fri, 9:30m-2:30pm

New permit parking area, restricting on-street parking to permit holders only during the restriction times to prevent non-resident parking. Permits are currently £40 per year

Visitors would require visitor parking permits, currently £1.20 per day

TONBRIDGE & MALLING
BOROUGH COUNCIL

STREETSCENE,
LEISURE &
TECHNICAL SERVICES

Transportation Team
Gibson Building
Gibson Drive
Kings Hill
West Malling
Kent ME19 4LZ
Tel: 01732 844522 Fax: 01732 876317

Project Title
Local Parking Plan - Phase 12
Informal consultation

Drawing Title
Tonbridge Shakespeare Road area

Drawn ACB	Checked AE	Date 7/2020
Scale 1 : 2000 @ A4		
Drawing No. DD/590/16		Rev

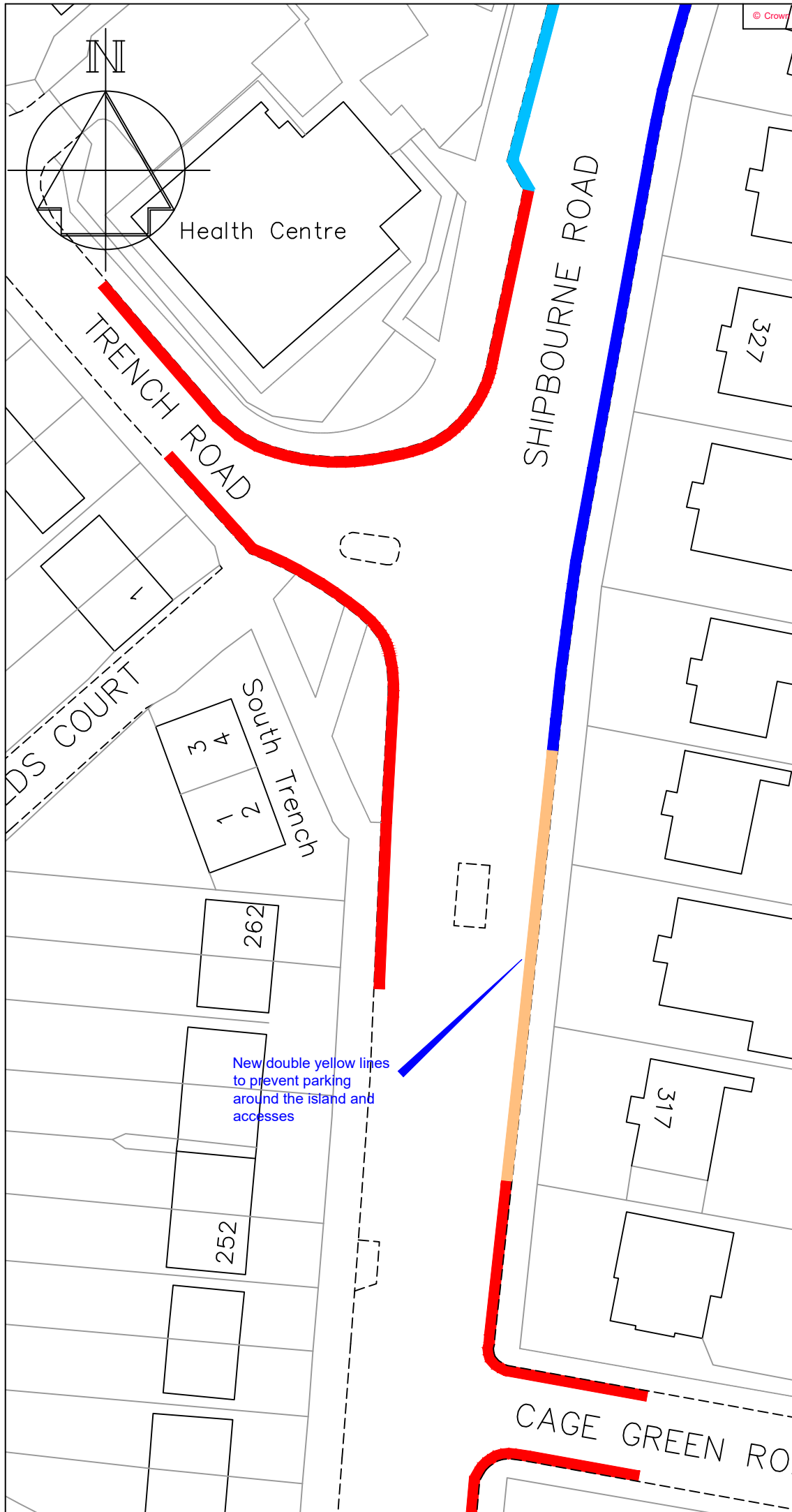

Key

- Existing "No waiting at any time" (double yellow lines)
- Existing "Limited Waiting, 8am-6pm, 2hrs no return 2 hours" parking bay
- Existing mandatory cycle lane (no parking allowed)
- Proposed "No waiting at any time" (double yellow lines)

Revision	Date



Technical Services
 Gibson Building
 Gibson Drive
 Kings Hill
 West Malling
 Kent ME19 4LZ
 Tel: 01732 844522 Fax: 01732 876317

Project Title
 Parking Action Plan
 Phase 12
 Informal consultation

Drawing Title
 Tonbridge
 Shipbourne Road

Drawn ACB Checked AE Date 6/2019

Scale 1 : 1000 @ A4

Drawing No. DD/590/17	Rev -
---------------------------------	-----------------

New double yellow lines to prevent parking around the island and accesses

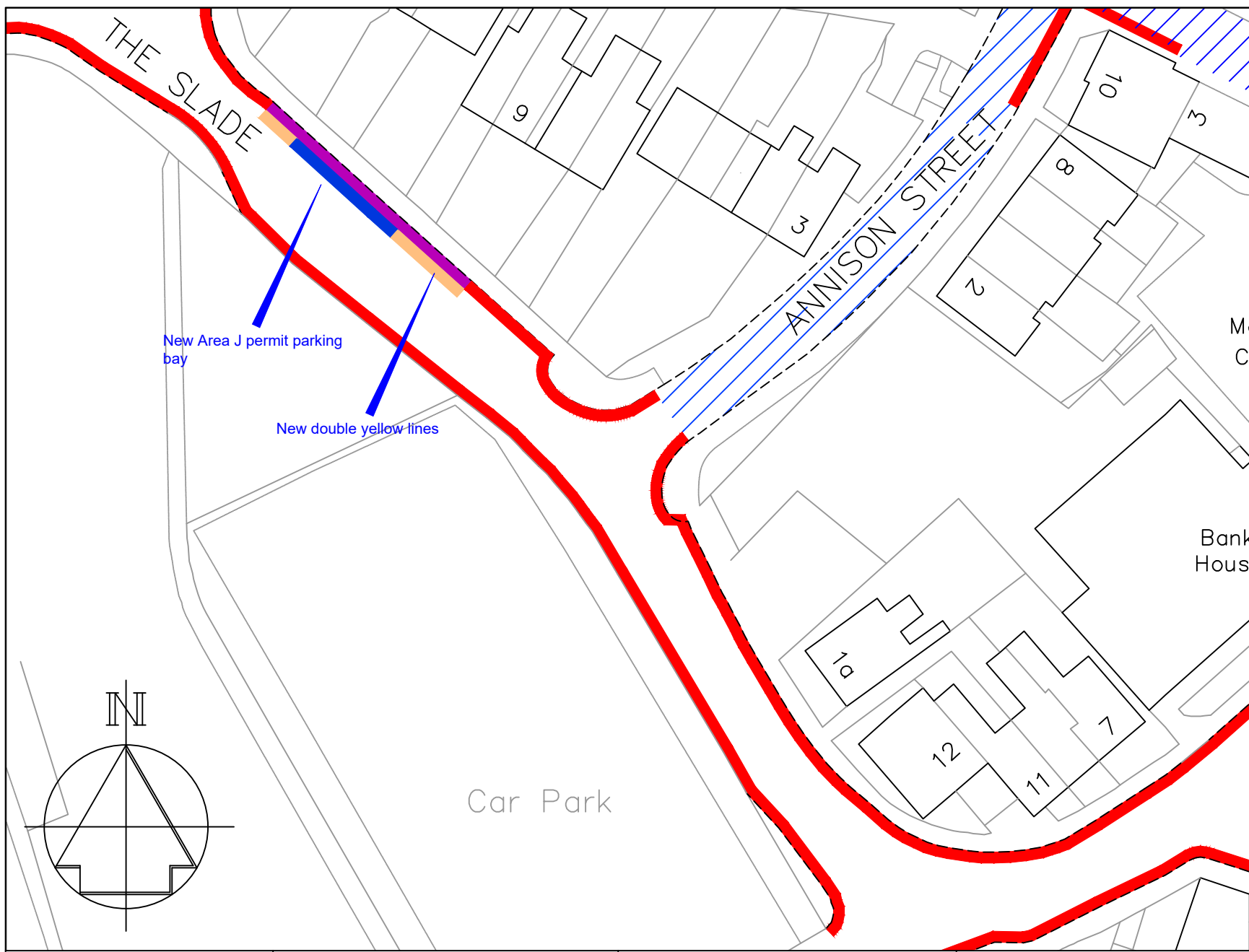

- ### Key
- Existing "No waiting at any time" (double yellow lines)
 - Existing "No waiting, Mon-Fri, 8am-6pm" (single yellow line)
 - Proposed "No waiting at any time" (double yellow lines)
 - Proposed "Resident permit parking, 7:30-9:30am & 4-8pm, Area J" (permit parking bay)

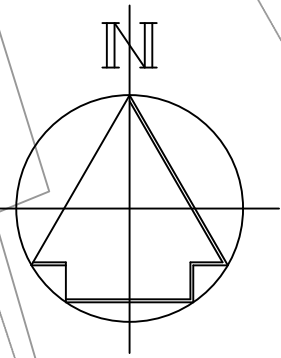

STREETSCENE,
LEISURE &
TECHNICAL SERVICES

Transportation Team
Gibson Building
Gibson Drive
Kings Hill
West Malling
Kent ME19 4LZ
Tel: 01732 844522 Fax: 01732 876317

Project Title
Parking Action Plan - Phase 12
Informal consultation

Drawing Title
Tonbridge
The Slade

-	-	-
Revision		Date

Drawn ACB	Checked AE	Date 7/2020
Scale 1 : 500 @ A4		

Drawing No. DD/590/18	Rev -
---------------------------------	-----------------

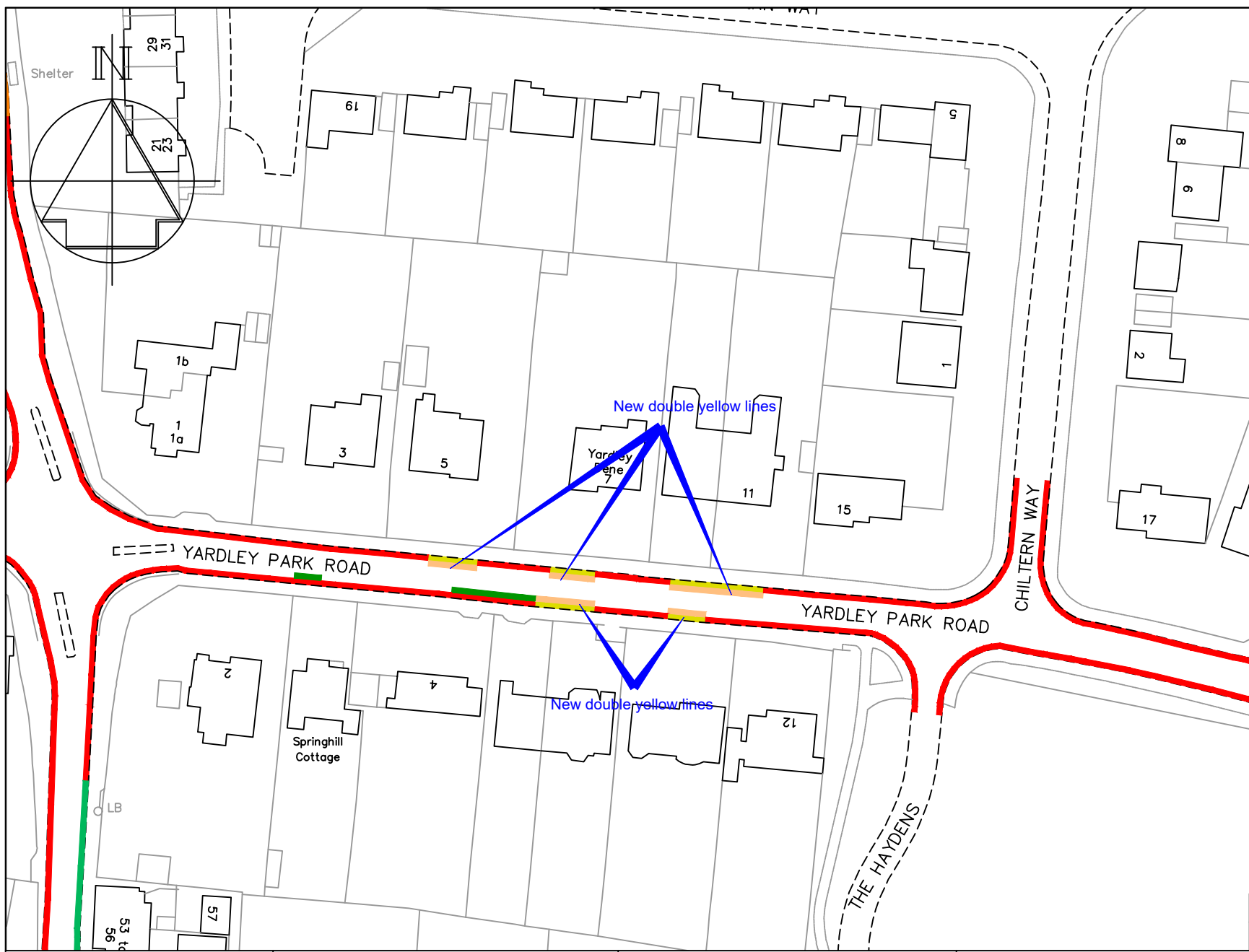

Key

- Existing "No waiting at any time" (double yellow lines)
- Existing "access protection" (white line)
- Existing "Limited waiting, Mon-Fri, 8am-6pm, 4hr, no return 4hr and Area K permits (Limited waiting and permit parking bay)"
- Proposed "Resident permit parking, 7:30-9:30am & 4-8pm, Area J" (permit parking bay)
- Proposed "No waiting at any time" (double yellow lines)

-	-
Revision	Date

TONBRIDGE & MALLING
BOROUGH COUNCIL

STREETSCENE,
LEISURE &
TECHNICAL SERVICES

Transportation Team
Gibson Building
Gibson Drive
Kings Hill
West Malling
Kent ME19 4LZ
Tel: 01732 844522 Fax: 01732 876317

Project Title
Parking Action Plan - Phase 12
Informal consultation

Drawing Title
Tonbridge
Yardley Park Road

Drawn ACB	Checked AE	Date 7/2020
Scale 1 : 1000 @ A4		
Drawing No. DD/590/19	Rev -	

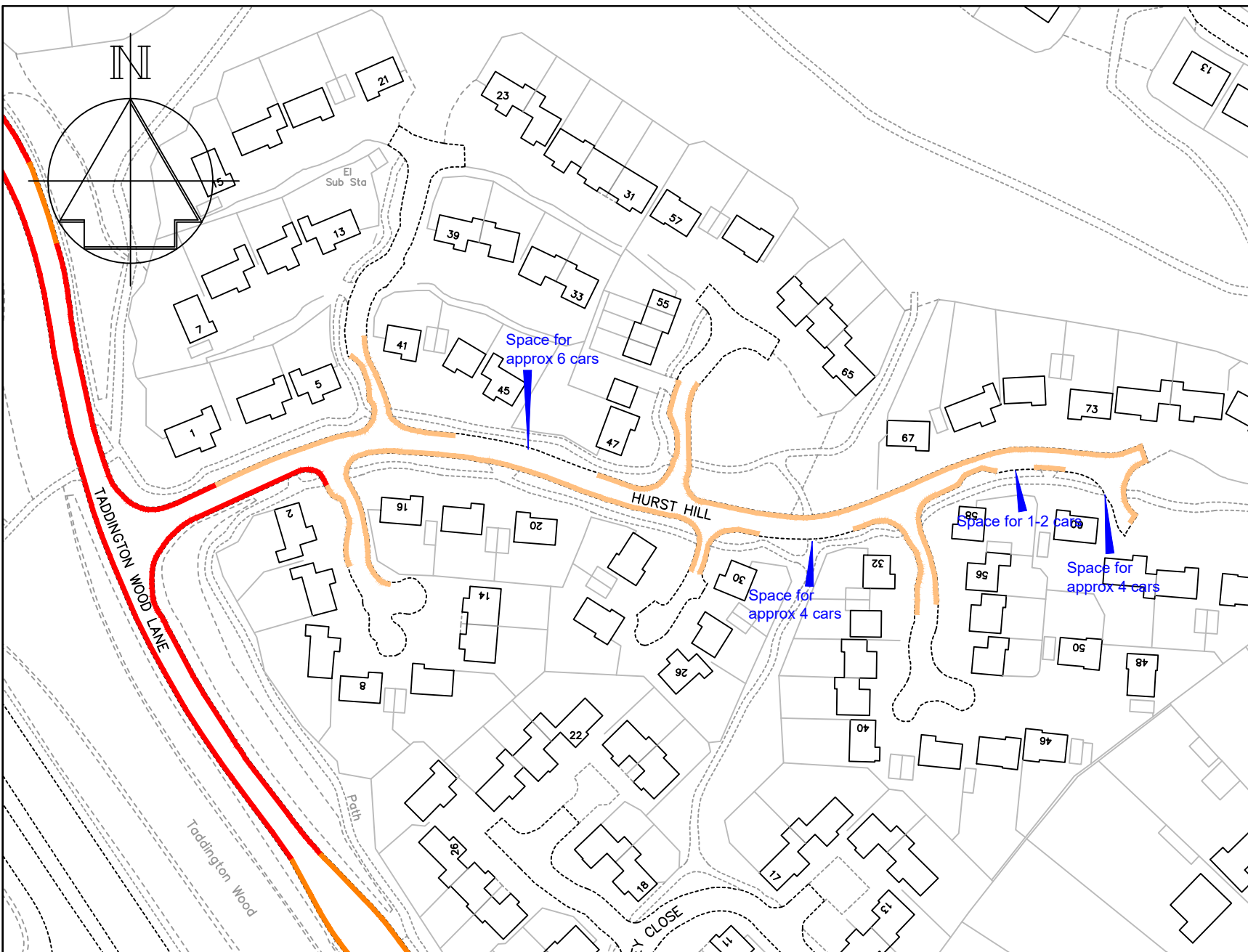

Key

- Existing "No waiting at any time" (double yellow lines)
- Existing bus stop clearways (yellow bus stop marking)
- Proposed "No waiting at any time" (double yellow lines)

Residents have reported Concerns over obstructive parking and emergency vehicle access.

The proposal is for new double yellow lines to prevent obstructive parking around junctions, narrowings and accesses, in line with the requirements of the Highway Code

-	-	-
Revision		Date

TONBRIDGE & MALLING
BOROUGH COUNCIL

STREETSCENE,
LEISURE &
TECHNICAL SERVICES

Transportation Team
Gibson Building
Gibson Drive
Kings Hill
West Malling
Kent ME19 4LZ
Tel: 01732 844522 Fax: 01732 876317

Project Title
Parking Action Plan - Phase 12
Informal consultation

Drawing Title
Walderslade Hurst Hill

Drawn ACB	Checked AE	Date 7/2020
Scale 1 : 1250 @ A4		
Drawing No. DD/590/20	Rev -	